

DIY-Door sign Home Sweet Home

Instructions No. 3367

Difficulty: Beginner 🍷🍷🍷🍷

Working time: 2 Hours

Design your own colorful door sign with Window Color

Are you ready to let your creativity run wild and give your home a personal touch? With a self-designed door sign, you can welcome your guests before they even open the door. Whether you want to use it for the entrance area or as a unique decoration in the interior, a handmade door sign is guaranteed to attract everyone's attention. In this tutorial, I'll show you how to use VBS Window Fantasy colors to create a vibrant and appealing door sign.



Step 1: Print out and prepare the template

To get started, print out the template for the door sign. The recommended size is 14 x 20 cm. If you prefer a

different size, simply adjust the template to your requirements on the computer or photocopier.

WINDOW COLOR TÜRSCHILD - VORLAGE
DIE ANLEITUNG DAZU FINDEST DU AUF [HTTP://VBS-HOBBY.COM/BLOG](http://vbs-hobby.com/blog)



Place the template in a brochure cover or on a glass plate and gently fix it in place with adhesive tape to ensure that it does not slip when painting.

Step 2: Trace the contours

Start by tracing the contours of the template. Hold the tip of the bottle about half a centimeter above the surface to create fine, even lines. For curved words such as "Home" and "Sweet", draw the outlines slightly outside the font to leave enough space between the letters.

If you are not sure about the outlines, test on a separate sheet first. This will prevent the actual motif from being damaged.

Step 3: Coloring the door sign

Now fill in the outlined areas with the bright colors Window Color Colors. Start with the outlines on the outside and work your way inwards. If there are any air bubbles, you can carefully prick them with a toothpick. Also use the toothpick to spread the colors evenly by making circular movements.

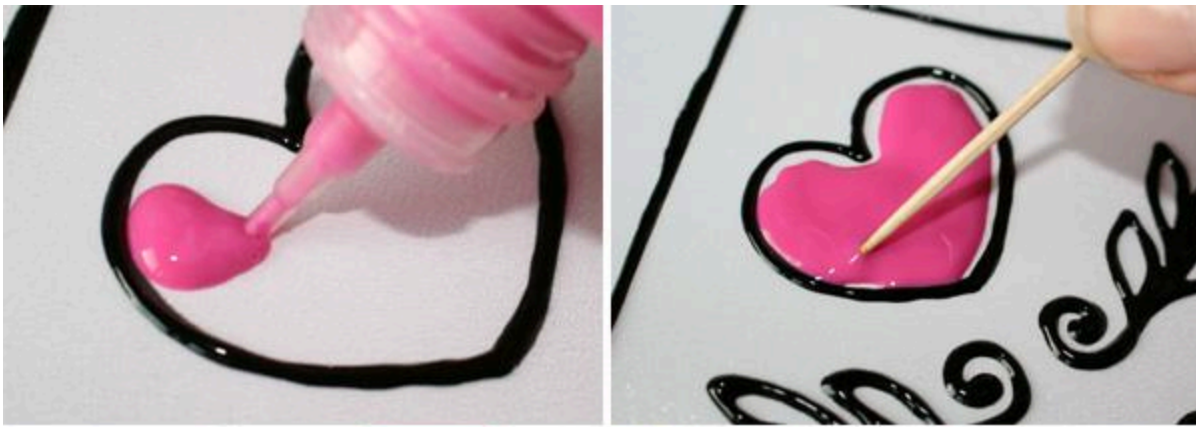

Once all the colored areas have been filled, the clear color is used. Add this to the remaining areas. Allow the door sign to dry until the colors appear transparent.



Finishing

Carefully remove the dry door sign from the film and place it in your desired location. The colors make it possible for the sign to adhere without additional mounting material.

Have fun designing your individual door sign!

Visit our online store now and get the best materials for your next project - let your creativity run wild! DIY-Project - let your creativity run wild!

Must Have

Permanently reduced



The image shows a product box for the KREUL Window Color Set "XXL". The box is light blue with a red ribbon tied around it. A yellow tag with "XXL" and "Contour set" is attached to the ribbon. The box features several colorful window color designs, including a large pink and blue flower and a blue starburst. Text on the box includes "KREUL", "WINDOW COLOR", and "Fensterfarbe für Konturmalerei". At the bottom of the box, there are images of the 9 color bottles and a black bottle.

KREUL Window Color Set "XXL"

9 colours & contour à 80 ml & extras

● **54,95 CHF**
57,95 CHF

[Item details](#)

Quantity: [Add to cart](#) 

Article information:

Article number	Article name	Qty
597067	KREUL Window Color Set "XXL"	1
754071-74	KREUL Window Color contour paint, 80 mlBlack	1
595179	Windmill / Mobile-Foil	1